

ONEPOINTE SOLUTIONS

LABORATORY | INDUSTRIAL | COMMERCIAL



METAL CASEWORK CATALOG

TABLE OF CONTENTS

| | |
|---------------------------------------|----------|
| Welcome | 2 |
| Quality Policy Statement | 3 |
| Warranty | 4 |
| Casework | |
| • Base Cabinets | 6 |
| • Sink & ISink Cabinets | 9 |
| • Wall Cabinets | 11 |
| • Tall Cabinets | 13 |
| • Waste Bin Cabinets | 15 |
| • Acid & Flammable Cabinets | 17 |
| • Vented/Vacuum Cabinets..... | 19 |
| • Corner Cabinets - Base | 21 |
| • Corner Cabinets - Wall | 23 |
| • Sliding Door Cabinets - Base | 25 |
| • Sliding Door Cabinets - Wall | 27 |
| • Sliding Door Cabinets - Tall | 29 |
| • Mobile Cabinets | 31 |
| Casework Accessories | |
| • Aprons & Fillers | 34 |
| • Shelving Systems | 35 |
| • Scribes | 36 |
| • Miscellaneous | 37 |
| • Concealed Hinges | 38 |
| Countertops & Worksurfaces | |
| • Laboratory Surfaces | 39 |
| • Commercial Surfaces | 40 |
| Finishes & Accessories | |
| • Powder Coat Colors | 41 |
| • Handles & Pulls | 42 |
| • Fume Hoods & Lab Fixtures | 43 |
| Important Information | |
| • Contact Us | 44 |
| • Nationwide Service | 44 |

WELCOME

We are honored that you are considering our metal casework for your laboratory, industrial, or commercial needs.

At OnePointe Solutions, we are continually improving the quality and versatility of our products to solve complex workspace issues. We strive to exceed each customer's expectations via our products and our outstanding customer support.

Our goal is to bring about change through better designs, higher quality components, and customer service that is second to none.

Whether your project calls for a single cabinet, a new multi-floor lab facility, or something in between we've got you covered!

We are OnePointe Solutions!



QUALITY STATEMENT

OnePointe Solutions' core business is the sale, design, layout, fabrication, and installation of custom industrial and laboratory furniture including casework, workbenches, fume hoods, and more. Our vision for growth and industry leadership is to provide aesthetically pleasing, functionally innovative, defect-free products in a timely manner.

We believe quality leadership in every functional area is necessary to remain a market leader, and as such continue to improve our Quality Management System (QMS) in line with the requirements of ISO 9001: 2015.

The OnePointe Solutions' executive team is committed to:

- Satisfying applicable requirements by ensuring that those of our customers along with any applicable statutory and regulatory requirements are determined, understood, and consistently met.
- Continuous improvement of the QMS as the governing strategic tool to capture, then communicate a shared vision to stakeholders, iterate on, and execute from with respect to achieving customer requirements and growing customer satisfaction.

The OnePointe Solutions' executive team shall:

- Maintain full accountability for the QMS.
- Consistently demonstrate quality leaderships in their respective areas of responsibility.
- Ensure the Quality Policy and respective quality objectives are established for the QMS and that they support the organizational context and strategy of the company.
- Establish quality objectives to be managed through performance data review, internal auditing, and the management review process to improve product quality, customer satisfaction and profitability.
- Utilize a process approach incorporating SIPOC and risk/opportunity based assessment.
Communicate and develop a shared understanding across the company as to the importance of quality management and QMS conformance.
- Ensure resources and personnel are available to execute to the intent and effectiveness of the QMS including providing time, training, and understanding of the strategy behind the QMS.
- Employ Kaizen as a tool for continuous improvement.
- Engage, direct, and support all personnel in their contribution towards the effective of the QMS and quality objectives.
- Partner with the supply chain on critical components to assure incorporated components meet performance and quality expectations.

This policy is communicated to all employees, organizations working in conjunction with OnePointe Solutions, and is provided to every quoted customer to share top management's vision and commitment to managing quality and continuous improvement in the design, manufacture and installation of beautiful industrial lab environments built to last.

Aaron Boto, CEO, OnePointe Solutions

WARRANTY

WHAT IS COVERED

OnePointe Solutions LLC ("OnePointe") warrants the products sold are free of defects in materials or workmanship to the Purchaser under normal use and service for the warranty periods specified with the exceptions stated below.

WHO IS COVERED

This limited warranty only applies to an original Purchaser located in the United States, Canada, or Mexico.

HOW LONG COVERAGE LASTS

Coverage duration is dependent on the item(s) purchased, please reference the table below for details. Due to the custom nature of OnePointe's products, there may be multiple items purchased, with different warranty durations. All warranties start from the date of shipment and run concurrently.

| Item | Duration | Item | Duration |
|--|----------|---|----------|
| Countertops | | Workbench Accessories | |
| Epoxy Resin* | 1 Year | Lighting* | 1 Year |
| Phenolic Resin* | 1 Year** | Power Distribution* | 1 Year |
| Laminate | 1 Year | Foot Options* | 1 Year |
| Maple Block* | 1 Year | Shelving | 5 Years |
| Stainless Steel | 1 Year | Hydraulic Lifts* | 1 Year |
| High Density Polyethylene (HDPE)* | 1 Year | Uprights | Lifetime |
| Workbench Frames | | Suspended Cabinets | 5 Years |
| Fully Welded | Lifetime | Integrated Technology* | 1 Year |
| Bolt Together | 5 Years | Electrostatic Discharge (ESD) Devices* | 1 Year |
| Casework / Fume Hoods | | Other Furnishings | |
| Metal | 5 Years | Chairs* | 15 Years |
| Metal w/ Wood Fascia | 1 Year | Service Fixtures* | 1 Year |
| Fume Hoods* | 1 Year | Lab Flooring* | 5 Years |
| Blowers* | 1 Year | Flammable / Chemical Safety Storage Cabinets* | 1 Year |
| *Item is supplied by a third party; specific warranty will be assigned to the fullest extent allowed. **10 Year Delamination Warranty | | | |

WHAT IS NOT COVERED

Defects resulting from normal wear and tear, color/grain variations, changes in surface finishes due to exposure to light, faulty installation, operation, disassembly, or remodeling, or from misuse, misapplication, neglect, abuse, accident, alteration, or the lack of proper maintenance, storage, cleaning, and care are not covered by OnePointe's limited warranty. Products that are exposed to extreme environmental conditions or that have been subject to improper storage are not covered by OnePointe's limited warranty. OnePointe does not provide warranty on components manufactured by others – only the original manufacturer's warranty applies.

WARRANTY

WHAT ONEPOINTE SOLUTIONS WILL DO

OnePointe, as its sole obligation, will repair or replace (at its option) any product, part, or component covered by this warranty which fails to perform to the product's specifications. If OnePointe acknowledges that any such defects found within the warranty period are the result of faulty material or workmanship, OnePointe will repair or replace the product, part, or component with a comparable product, part, or component at its own expense. OnePointe may elect to provide on-site repair of defective product and in these cases, Buyer agrees to allow OnePointe factory technicians or authorized representative reasonable and timely access to jobsite during normal business hours. Repairs or replacement of product under warranty does not extend the original warranty period.

THERE ARE NO OTHER WARRANTIES, EXPRESSED OR IMPLIED, WHICH EXTEND BEYOND THE FACE HEREOF INCLUDING, WITHOUT LIMITATION, WARRANTIES OF MERCHANTABILITY OR FITNESS FOR A PARTICULAR USE.

The liability and remedy set forth above, in the event of a breach by OnePointe of its warranties set forth above or any of the covenants or agreements relating to the sale of the products to the Purchaser, shall be the sole and exclusive remedy to the Purchaser. In no event shall OnePointe's liability exceed the amount paid, excluding installation, by the Purchaser to OnePointe or any of its dealers or agents for the products to which the breach applies.

In no event shall OnePointe be liable to the Purchaser for any consequential or indirect damages including, but not limited to, loss of income, revenue, or profits in the event of a breach of any of the warranties or other covenants made by OnePointe with respect to the sale of OnePointe products to the Purchaser. The foregoing may not be modified except by a written amendment signed by OnePointe. The Purchaser, by accepting delivery of any product manufactured by OnePointe, hereby accepts the foregoing, and expressly waives any other remedy and damages, direct, indirect, and consequential.

HOW TO GET SERVICE

Contact OnePointe Solutions for any warranty questions or claims by phone **512.652.6292**, or email **warranty@onepointesolutions.com**. No product or parts thereof shall be returned to OnePointe or any of its dealers or agents without OnePointe's prior written consent. Product returned to OnePointe shall be shipped at buyers cost and risk of loss. Replacement product shall be returned at OnePointe's cost and risk of loss.

HOW STATE LAW APPLIES

This warranty gives you specific legal rights, and you may also have other rights which vary from state to state.



BASE CABINETS

Base cabinets are the true soul of the lab. They set the tone for the space and provide easy access to materials, tools, or whatever you use in your facility that you need at your disposal.

Our metal cabinets are fully welded and manufactured with cold-rolled powder-coated steel or 304 stainless steel to fulfill different requirements in your space. Each cabinet comes with soft-close hinges, drawer slides, and a variety of heights, widths, and depths to choose from to create the ideal cabinet for you.

Built to be long-lasting and SEFA certified, our base cabinets are unique to you and your space.

Features

- 18 GA Sheet Metal Construction
- 3" Depth & 4" Height Toe Kick
- Removable Back Panel For Service Access
- Soft-Closing Doors and Drawers
- 1x Adjustable Shelf



Understanding The Configuration Number

Using the model below, you will be able to better specify a cabinet configuration for your project.

BASE

Cabinet Type

-

HHWWDD

Cabinet Dimensions

-

01L/RX

Drawers, Doors & Locking

-

A/W

Pull/ Handle Type

Drawers, Doors, Locking & Pull Details

I. Drawers

- First Number: # of Drawers (0 to 6)

II. Doors

- Second Number: # of Doors (0 to 2)
- L or R: Left or right hinged single door.
- For double doors, leave blank.

III. Locking

- X : Locking
- No for locks, leave blank.

IV. Pulls

- A: Aluminum Pull
- W: Stainless Steel Wire Pull

Example: BASE-321818-01RX-A

Base Cabinet with 32" H x 18" W x 18" D, 0 Drawers, 1 Right Hinged Door, Locking, Aluminum Pull

BASE CABINET CONFIGURATIONS

SITTING

ADA

STANDARD

STANDING

HEIGHTS

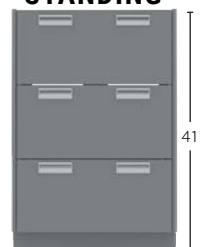
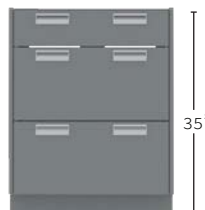
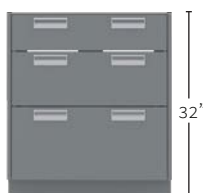
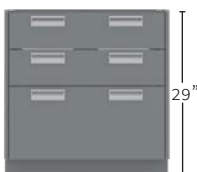

BASE-HHWDD-20X-A/W

2 DRAWER BASE CABINETS ARE ONLY AVAILABLE IN SITTING HEIGHT (29").

2 DRAWERS



BASE-HHWDD-30X-A/W

3 DRAWERS



BASE-HHWDD-40X-A/W

4 DRAWERS



BASE-HHWDD-50X-A/W

5 DRAWERS



BASE-HHWDD-60X-A/W

6 DRAWERS



BASE CABINET CONFIGUARTIONS

1 DOOR

BASE-HHWDD-0L/RX-A/W



(L)



(R)

BASE CABINETS WITH WIDTHS LESS THAN 30" WILL HAVE (1) DOOR.

2 DOORS

BASE-HHWDD-02X-A/W



BASE CABINETS WITH WIDTHS OF 30" OR MORE WILL HAVE (2) DOORS.

DUAL COMBINATIONS



BASE-HHWDD-11L/RX-A/W



BASE-HHWDD-21L/RX-A/W



BASE-HHWDD-12X-A/W



BASE-HHWDD-22X-A/W

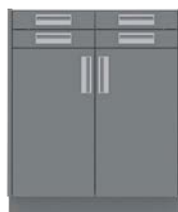

BASE-HHWDD-42X-A/W

BASE CABINET CONFIGURATION OPTIONS

| HEIGHTS | WIDTHS | DEPTHS | DRAWERS |
|-------------------|---|----------------------------------|--|
| 29", 32", 35", 41 | 12", 15", 18", 21" 24", 30", 36", 42", 48" | 18", 22" | 0 TO 6 |
| DOORS | HINGE DIRECTION | LOCKING | PULLS |
| 0 TO 2 | L = LEFT R = RIGHT SKIP FOR DOUBLE DOOR | X = LOCKING SKIP FOR NO LOCKS | A = ALUMINUM PULL W = WIRE STAINLESS PULL |

SINK & ISINK CABINETS

Sink cabinets are useful for installing sinks in a cabinet run as well as having easy access to sink usage in your environment too. Each cabinet comes with soft-close hinges, 3" depth and 4" height toe kick, a removable false bottom for plumbing and back panel for service access.

They are available in (4) standard heights and manufactured in cold-rolled powder-coated steel or 304 stainless steel to accommodate different area requirements. Designed to be long-lasting and SEFA certified, our sink cabinets are a great addition for your facility needs.

Features

- 18 GA Sheet Metal Construction
- 3" Depth & 4" Height Toe Kick
- Removable Back Panel for Service Access
- Soft-Closing Doors
- Removable False Bottom for Plumbing Connection from the Floor



Understanding The Configuration Number

Using the model below, you will be able to better specify a cabinet configuration for your project.

SINK

Cabinet Type

-

HHWWDD

Cabinet Dimensions

-

L / R X

Doors & Locking

-

A/W

Pull/ Handle Type

Doors, Locking & Pull Details

I. Doors

- L or R: Left or right hinged single door.
- For double doors, leave blank.

II. Locking

- X : Locking
- No for locks, leave blank.

III. Pulls

- A: Aluminum Pull
- W: Stainless Steel Wire Pull

Example: SINK-352422RX-A

Sink Cabinet with 35" H x 24" W x 22" D, Single Right Hinged Door, Locking, Aluminum Pull

SINK & ISINK CABINET CONFIGURATIONS

HEIGHTS

SITTING

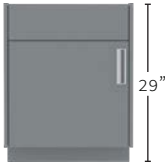

ADA

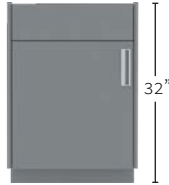

STANDARD

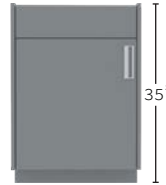

STANDING

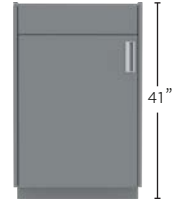

1 DOOR

SINK-HHWDD-1L/RX-A/W



SINK CABINETS WITH WIDTHS LESS THAN 30" WILL HAVE (1) DOOR.

2 DOORS

SINK-HHWDD-X-A/W



SINK CABINETS WITH WIDTHS OF 30" OR MORE WILL HAVE (2) DOORS.

ISINK

ISINK-HHWDD-X-A/W



Note: The following dimensions are available for ISINKs:
 (HH): 29", 35", 41"
 (WW): 52", 58"
 (DD): 18", 22"
 ISINKS will come with (2) doors by default.

SINK & ISINK CABINET CONFIGURATION OPTIONS

| HEIGHTS | WIDTHS | DEPTHS |
|---|---|--|
| 29", 32", 35", 41" | 15", 18", 21", 24", 30", 36", 42", 48", 52", 58" | 18", 22" |
| HINGE DIRECTION | LOCKING | PULLS |
| L = LEFT, R = RIGHT WIDTHS > 24" WILL HAVE DOUBLE DOORS | X = LOCKING SKIP FOR NO LOCKS | A = ALUMINUM PULL W = WIRE STAINLESS PULL |

WALL CABINETS

Wall cabinets can help you create your ideal environment while providing accessible storage within arm's reach and making the most of your space as well. We manufacture our wall cabinets from cold-rolled powder-coated steel or 304 stainless steel to meet the different requirements of your facility.

Our wall cabinets come in a variety of sizes and options so that you can choose a configuration that works for you. Each of our wall cabinets comes with soft-closing doors, adjustable shelves and we also provide (4) types of doors: solid, acrylic, glass, or open (no door).

Designed to be long-lasting and SEFA certified, our wall cabinets are great for your storage needs.

Features

- 18 GA Sheet Metal Construction
- 4 Door Options: Acrylic, Solid, Glass, or Open
- Soft-Closing Doors
- 1x Adjustable Shelf
- 2x Adjustable Shelves (Height > 24")

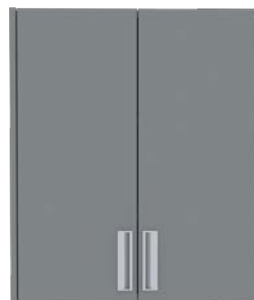

Understanding The Configuration Number

Using the model below, you will be able to better specify a cabinet configuration for your project.

WALL - **HHWWDD** **L/R** - **SHX** - **A/W**

Cabinet Type Cabinet Dimensions Doors Door Type & Locking Pull/ Handle Type

Doors, Locking & Pull Details

| | | | |
|--|---|--|--|
| I. Doors <ul style="list-style-type: none">• L or R: Left or right hinged single door.• For double doors, leave blank. | II. Door Type <ul style="list-style-type: none">• S: Solid Door• A: Acrylic Door• G: Glass Door• O: Open Door | III. Locking <ul style="list-style-type: none">• X : Locking• No for locks, leave blank. | IV. Pulls <ul style="list-style-type: none">• A: Aluminum Pull• W: Stainless Steel Wire Pull |
|--|---|--|--|

Example: WALL-482416L-SHX-A

Wall Cabinet with 48" H x 24" W x 16" D, Solid Left Hinged Door, Locking, Aluminum Pull

WALL CABINETS CONFIGURATIONS

HEIGHTS

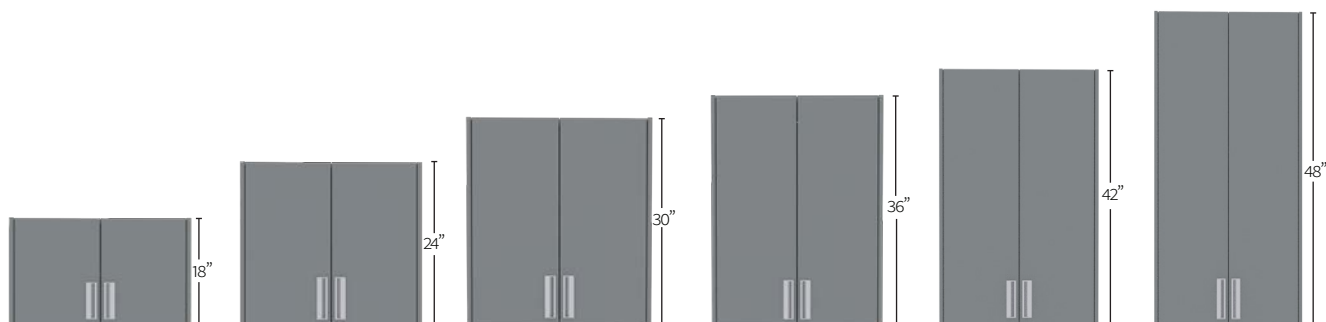

SOLID

WALL-HHWDDL/R-SHX-A/W

WALL-HHWDD-SHX-A/W



ACRYLIC

WALL-HHWDDL/R-AHX-A/W

WALL-HHWDD-AHX-A/W

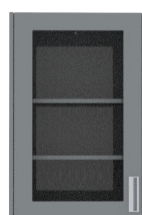

GLASS

WALL-HHWDDL/R-GHX-A/W

WALL-HHWDD-GHX-A/W



OPEN

WALL-HHWDD-O



WALL CABINET CONFIGURATION OPTIONS

| HEIGHTS | WIDTHS | DEPTHS | HINGE DIRECTION |
|---|---|----------------------------------|---|
| 18", 24", 30", 36", 42", 48" | 12", 15", 18", 21" 24", 30", 36", 42", 48" | 13", 16" | L = LEFT R = RIGHT WIDTHS > 24" WILL HAVE DOUBLE DOORS |
| DOOR TYPE | HINGED DOOR | LOCKING | PULLS |
| S= SOLID G= GLASS A= ACRYLIC O = OPEN | H | X = LOCKING SKIP FOR NO LOCKS | A = ALUMINUM PULL W = WIRE STAINLESS PULL |

TALL CABINETS

Tall cabinets are the perfect storage solution for storing more in a smaller footprint. Coming at a standard height of 84", they are built to hold more than any other cabinet.

Our tall cabinets are manufactured by your choice of either cold-rolled powder-coated steel or 304 stainless steel to accommodate different storage requirements. You can select from multiple widths and depths to configure the right tall cabinet for you.

Designed to be long-lasting and SEFA certified, our tall cabinets are the absolute best for your storage needs.

Features

- 18 GA Sheet Metal Construction
- 4 Door Options: Acrylic, Solid, Glass, or Open
- Soft-Closing Doors
- 3" Depth & 4" Height Toe Kick
- 5x Adjustable Shelves



Understanding The Configuration Number

Using the model below, you will be able to better specify a cabinet configuration for your project.

TALL

Cabinet Type

- **HHWWDD** -

Cabinet Dimensions

- **AHL/RX** -

Doors & Locking

- **A/W**

Pull/ Handle Type

Doors, Locking & Pull Details

| I. Door Type | II. Doors | III. Locking | IV. Pulls |
|---|--|--|---|
| <ul style="list-style-type: none">• S: Solid Door• A: Acrylic Door• G: Glass Door• O: Open Doors | <ul style="list-style-type: none">• L or R: Left or right hinged single door.• For double doors, leave blank. | <ul style="list-style-type: none">• X : Locking• No for locks, leave blank. | <ul style="list-style-type: none">• A: Aluminum Pull• W: Stainless Steel Wire Pull |

Example: TALL-842418-AHLX-W

Tall Cabinet with 84" H x 24" W x 18" D, Acrylic Left Hinged Door, Locking, Stainless Steel Wire Pull

TALL CABINET CONFIGURATIONS

HEIGHTS

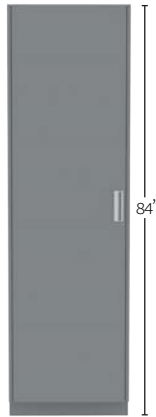

SOLID

TALL-HHWDD-SHL/RX-A/W



TALL-HHWDD-SHX-A/W



ACRYLIC

TALL-HHWDD-AHL/RX-A/W



TALL-HHWDD-AHX-A/W



GLASS

TALL-HHWDDL/R-GHX-A/W



TALL-HHWDD-GHX-A/W



OPEN

TALL-HHWDD-O



TALL CABINET CONFIGURATION OPTIONS

| HEIGHTS | WIDTHS | DEPTHS | DOOR TYPE |
|-------------|---|----------------------------------|--|
| 84" | 12", 15", 18", 21" 24", 30", 36", 42", 48" | 13", 16", 18", 22" | S= SOLID G= GLASS A= ACRYLIC O = OPEN |
| HINGED DOOR | HINGE DIRECTION | LOCKING | PULLS |
| H | L = LEFT R = RIGHT WIDTHS > 24" WILL HAVE DOUBLE DOORS | X = LOCKING SKIP FOR NO LOCKS | A = ALUMINUM PULL W = WIRE STAINLESS PULL |

WASTE BIN CABINETS

Our waste bin cabinets provide a discreet way to throw away trash and debris to ensure your environment is always clean and clear. They can easily fit into a run of cabinets, come in a range of (4) standard sizes, and are made with cold-rolled powder-coated steel.

Like all our cabinets, you can select from multiple widths and depths to create the right cabinet for you. Designed to be long-lasting and SEFA certified, our waste bin cabinets are the perfect addition to your workspace needs.

Features

- 18 GA Sheet Metal Construction
- 3" Depth & 4" Height Toe Kick
- Removable Back Panel for Service Access
- Soft-Closing Drawers
- 1x Adjustable Shelf



Understanding The Configuration Number

Using the model below, you will be able to better specify a cabinet configuration for your project.

WASTE

-

HHWWDD

-

A/W

Cabinet Type

Cabinet Dimensions

Pull/ Handle Type

Pull Details

I. Pulls

- A: Aluminum Pull
- W: Stainless Steel Wire Pull

Example: WASTE-291522-W

Waste Cabinet with 29" H x 15" W x 22" D, Stainless Steel Wire Pull

WASTE BIN CABINET CONFIGURATIONS

HEIGHTS

SITTING

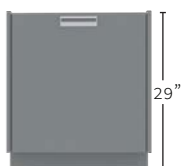

ADA



STANDARD



STANDING

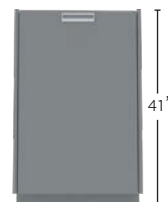

1 DRAWER

WASTE-HHWWDD-A/W



WASTE CABINETS WITH WIDTHS LESS THAN OR EQUAL TO 24" WILL HAVE (1) DRAWER.

2 DRAWERS

WASTE-HHWWDD-A/W



WASTE CABINETS WITH WIDTHS GREATER THAN OR EQUAL TO 30" WILL HAVE (2) DRAWERS.

WASTE BIN CABINET CONFIGURATION OPTIONS

| HEIGHTS | WIDTHS | DEPTHS |
|---|--|----------|
| 29", 32", 35", 41" | 15", 18", 21", 24", 30", 36", 42", 48", 52", 58" | 18", 22" |
| DRAWERS | PULLS | |
| 1 DRAWER FOR WIDTHS \leq 24" 2 DRAWERS FOR WIDTHS \geq 30" | A = ALUMINUM PULL W = WIRE STAINLESS PULL | |

ACID & FLAMMABLE CABINETS

Our acid and flammable cabinets are a great option if you need to store hazardous materials in a safe space. Each is powder-coated with an interior plasti-coat for chemical resistance against hazardous materials present in the substances.

The doors are sealed with a fiberglass roped gasket to ensure there is no escape of fumes or gaseous chemicals. In addition, our flammable cabinets come with hydraulic-actuated self-closing doors to ensure doors are not accidentally left open to prevent flammable gaseous fumes from escaping.

Designed to be long-lasting and SEFA certified, our acid and flammable cabinets are the perfect addition to your laboratory.

Features

- Leveling Screws
- 1x Adjustable Shelf
- 3" Depth & 4" Height Toe Kick
- Removable Back Panel for Service Access
- Self-Locking Automatic Latch Used for Door Closing
- Bottom Sump Pan to Contain Any Accidental Spills



Understanding The Configuration Number

Using the model below, you will be able to better specify a cabinet configuration for your project.

ACID/FLAM - **HHWWDD** - **L / R** - **SC***

Cabinet Type Cabinet Dimensions Doors & Locking Self-Closing Door

Door Details

I. Doors

- L or R: Left or right hinged single door.
- For double doors, leave blank.
- *SC: Flammable cabinets only

Example: ACID-352418-L

Acid Cabinet with 35" H x 24" W x 18" D, Left Hinged Door

ACID & FLAMMABLE CABINET CONFIGURATIONS

HEIGHTS

SITTING



ADA

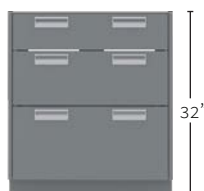

STANDARD



ACID

ACID-HHWDD-L/R



ACID-HHWDD



FLAMMABLE

FLAM-HHWDDL/R-SC



FLAM-HHWDD-SC



ACID & FLAMMABLE CABINET CONFIGURATION OPTIONS

| HEIGHTS | WIDTHS | DEPTHS |
|--|--|---------------------------------|
| 29", 32", 35" | 24", 30", 36", 42", 48" SINGLE DOOR & HINGE DIRECTION FOR ONLY 24" DIRECTION | 18", 22" |
| HINGE DIRECTION | | SELF-CLOSING DOOR |
| L = LEFT, R = RIGHT LEAVE BLANK FOR 2 DOORS 2 DOORS FOR WIDTHS ≥ 30" | | SC* *FLAMMABLE CABINETS ONLY |

VENTED/VACUUM CABINETS

Elevate your workspace with our Vented/Vacuum Cabinets, providing an optimal solution for safely storing equipment that generates high heat and noise. These cabinets are powder-coated and come with a sound deafening foam interior that minimizes pump noise.

Featuring specially designed louvers in the doors, these cabinets allow for efficient airflow, aiding in heat dissipation and maintaining a controlled environment. Designed for convenience, our Vented/Vacuum Cabinets feature a vacuum pump tray that rolls in and out for easy access and storage.

SEFA certified and durable, our Vented/Vacuum Cabinets make the perfect addition to your workspace where functionality, safety, and innovation converge.

Features

- Sound Deafening Foam Interior
- Roll Out Vacuum Pump Tray
- Separate Compartment for Electrical Components
- Integral Toe Kick
- Red Light Toggle Switch with Pre-Wired Receptacle



Understanding The Configuration Number

Using the model below, you will be able to better specify a cabinet configuration for your project.

VACUUM - **HHWWDD** - **L / R X** - **A/W**

Cabinet Type Cabinet Dimensions Doors & Locking Pull/ Handle Type

Door Details

I. Doors

- L or R: Left or right hinged single door.
- For double doors, leave blank.

Example: VACUUM-412422LX-W

Vented Cabinet with 41" H x 24" W x 22" D, Left Hinged Door, Wire Pull

VENTED/VACUUM CABINET CONFIGURATIONS

HEIGHTS

SITTING

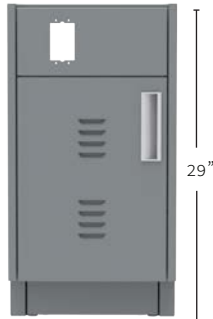

ADA



STANDARD



STANDING

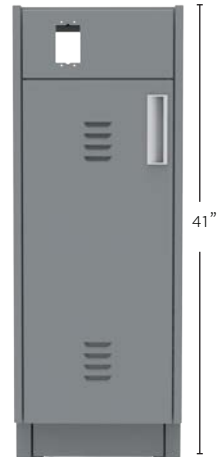

1 DOOR

VACUUM-HHWDD-L/R



2 DOOR

VACUUM-HHWDD



VACUUM CABINETS WITH WIDTHS LESS THAN OR EQUAL TO 24" WILL HAVE (1) DOOR.

VACUUM CABINETS WITH WIDTHS GREATER THAN OR EQUAL TO 30" WILL HAVE (2) DOORS.

VENTED/VACUUM CABINET CONFIGURATION OPTIONS

| HEIGHTS | WIDTHS | DEPTHS |
|---|--|--|
| 29", 32", 35", 41" | 15", 18", 21", 24", 30", 36", 42", 48" | 20", 22" |
| HINGE DIRECTION | | PULLS |
| L = LEFT, R = RIGHT LEAVE BLANK FOR 2 DOORS 2 DOORS FOR WIDTHS $\geq 30"$ | | A = ALUMINUM PULL W = WIRE STAINLESS PULL |

CORNER CABINETS - BASE

When you want a cabinet to fit that certain corner in your lab, our corner cabinets are the perfect solution. Just like our standard base cabinets, our corner base cabinets also aid in setting the tone for your lab and provide easy access to materials, tools, or whatever you use in your facility that you need at your disposal.

Each cabinet is fully welded and manufactured with cold-rolled powder-coated steel and comes with soft-close hinges. In addition, like the rest of our cabinets, there are variety of heights, widths, and depths to choose from to create the ideal cabinet for you.

Built to be long-lasting and SEFA certified, our corner base cabinets are unique to you and your space.

Features

- 18 GA Sheet Metal Construction
- 3" Depth & 4" Height Toe Kick
- Removable Back Panel for Service Access
- Soft-Closing Doors
- 1x Adjustable Shelf



Understanding The Configuration Number

Using the model below, you will be able to better specify a cabinet configuration for your project.

CBASE

Cabinet Type

-

HHWWDD

Cabinet Dimensions

-

L / R X

Doors & Locking

-

A/W

Pull/ Handle Type

Doors, Locking & Pull Details

I. Doors

- L or R: Left or right hinged single door.
- For no doors, leave blank.

II. Locking

- X : Locking
- No for locks, leave blank.

III. Pulls

- A: Aluminum Pull
- W: Stainless Steel Wire Pull

Example: CBASE-411822-01R-W

Corner Base Cabinet with 41" H x 18 W x 22 D, Right Hinged Door, No Locks, Stainless Steel Wire Pull

BASE CORNER CABINET CONFIGURATIONS

HEIGHTS

SITTING



ADA



STANDARD

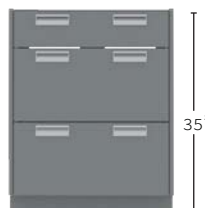

STANDING

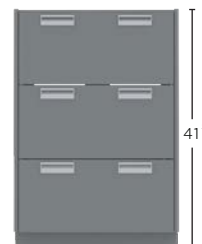

OPEN

CBASE-HHWWDD-00



1 DOOR

CBASE-HHWWDD-L/RX-A/W



CORNER BASE & WALL CABINET CONFIGURATION OPTIONS

| HEIGHTS | WIDTHS | DEPTHS | DOORS |
|--|----------------------------------|--|--------|
| 29", 32", 35", 41" | 18" | 18", 22" | 0 TO 1 |
| HINGE DIRECTION | LOCKING | PULLS | |
| L = LEFT, R = RIGHT SKIP FOR NO DOORS | X = LOCKING SKIP FOR NO LOCKS | A = ALUMINUM PULL W = WIRE STAINLESS PULL | |

CORNER CABINETS - WALL

Along with our corner base cabinets, we also offer them in wall configurations as well. Our corner wall cabinets come in a variety of sizes and options so that you can choose a configuration that works for you.

Just like our standard wall cabinets, each comes with soft-closing doors, adjustable shelves, (4) types of doors: solid, acrylic, glass, or open (no door) and are manufactured from cold-rolled powder-coated steel too.

Built to be long-lasting and SEFA certified, our corner wall cabinets are unique to you and your space.

Features

- 18 GA Sheet Metal Construction
- 4 Door Options: Acrylic, Solid, Glass, or Open
- Soft-Closing Doors
- 1x Adjustable Shelf
- 2x Adjustable Shelves (Height > 24")



Understanding The Configuration Number

Using the model below, you will be able to better specify a cabinet configuration for your project.

CWALL - **HHWWDD** **L / R** - **SHX** - **A/W**
Cabinet Type Cabinet Dimensions Doors Door Type & Locking Pull/ Handle Type

Doors, Locking & Pull Details

| I. Doors | II. Door Type | III. Locking (Base & Wall) | IV. Pulls |
|---|--|--|---|
| <ul style="list-style-type: none">• L or R: Left or right hinged single door. | <ul style="list-style-type: none">• S: Solid Door• A: Acrylic Door• G: Glass Door• O: Open Door | <ul style="list-style-type: none">• X : Locking• No for locks, leave blank. | <ul style="list-style-type: none">• A: Aluminum Pull• W: Stainless Steel Wire Pull |

Example: CWALL-1818161L-GH-A

Corner Wall Cabinet with 18" H x 18" W x 16", Glass Left Hinged Door, Aluminum Pull

WALL CORNER CABINET CONFIGURATIONS

HEIGHTS

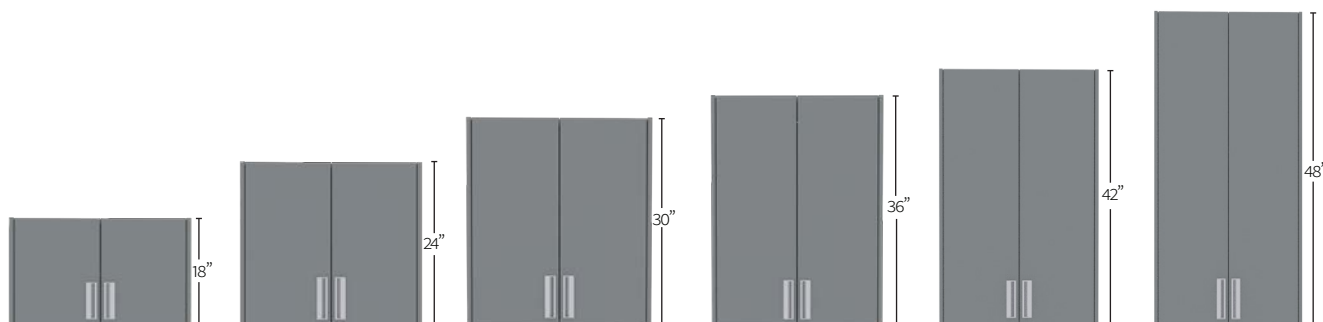

SOLID

CWALL-HHWDDL/R-SHX-A/W



ACRYLIC

CWALL-HHWDDL/R-AHX-A/W



GLASS

CWALL-HHWDDL/R-GHX-A/W



OPEN

CWALL-HHWDDL/R-GHX-A/W



CORNER BASE & WALL CABINET CONFIGURATION OPTIONS

| HEIGHTS | | WIDTHS | | DEPTHS | | DOORS | | | |
|--|--|---|--|----------|--|----------------------------------|--|--|--|
| 18, 24", 30", 36", 42", 48" | | 18" | | 13", 16" | | 0 TO 1 | | | |
| HINGE DIRECTION | | DOOR TYPE* | | HINGE* | | LOCKING | | PULLS | |
| L = LEFT R = RIGHT SKIP FOR NO DOORS | | S = SOLID G = GLASS A = ACRYLIC O = OPEN | | H | | X = LOCKING SKIP FOR NO LOCKS | | A = ALUMINUM PULL W = WIRE STAINLESS PULL | |

SLIDING DOOR CABINETS - BASE

Maximize your storage capacity while minimizing your footprint with our Sliding Door Cabinets. These cabinets are expertly engineered to provide unmatched storage capabilities, while their sliding doors ensure efficient use of space in your room.

Our tall cabinets are manufactured by your choice of either cold-rolled powder-coated steel or 304 stainless steel to accommodate different storage requirements. You can select from four heights, and a variety of widths and depths to configure the right tall cabinet for you.

Designed to be long-lasting and SEFA certified, our sliding door base cabinets are the perfect addition to your space.

Features

- 18 GA Sheet Metal Construction
- 3 Door Options: Acrylic, Solid, or Glass
- 1x Adjustable Shelf
- 2x Adjustable Shelves (Height > 24")

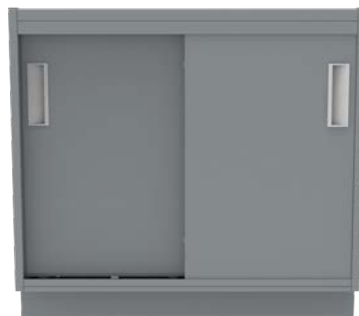

Understanding The Configuration Number

Using the model below, you will be able to better specify a cabinet configuration for your project.

BASE - **2** - **HHWWDD** - **2D** - **XS** - **A/W**

Cabinet Type Sliding Cabinet Dimensions Doors Door Type & Locking Pull/ Handle Type

Doors, Locking & Pull Details

| | | | |
|---|---|---|---|
| I. Doors <ul style="list-style-type: none">• 2 Door Requirement | II. Door Type <ul style="list-style-type: none">• S: Solid Door• A: Acrylic Door• G: Glass Door | III. Locking (Base & Wall) <ul style="list-style-type: none">• X : Locking• No for locks, leave blank. | IV. Pulls <ul style="list-style-type: none">• A: Aluminum Pull• W: Stainless Steel Wire Pull |
|---|---|---|---|

Example: BASE-2-323018-2D-XG-A

Base Sliding Door Cabinet with 32" H x 30" W x 18", Locking Glass Door, Aluminum Pull

BASE SLIDING DOOR CABINET CONFIGURATIONS

HEIGHTS

SITTING



ADA



STANDARD



STANDING



SOLID

BASE-2-HHWWDD-2D-S-A/W



GLASS

BASE-2-HHWWDD-2D-G-A/W



ACRYLIC

BASE-2-HHWWDD-2D-A-A/W



BASE SLIDING DOOR CABINET CONFIGURATION OPTIONS

| HEIGHT | WIDTHS | DEPTHS | DOORS |
|--------------------|--------------------|----------|-------|
| 29", 32", 35", 41" | 30", 36", 42", 48" | 18", 22" | 2 |

| DOOR | LOCKING | PULLS |
|---------------------------------------|----------------------------------|--|
| S = SOLID G = GLASS A = ACRYLIC | X = LOCKING SKIP FOR NO LOCKS | A = ALUMINUM PULL W = WIRE STAINLESS PULL |

SLIDING DOOR CABINETS - WALL

Transform your space with our sliding door wall cabinets, delivering both practical storage and an optimized environment. Each sliding door wall cabinet is equipped with adjustable shelves, and the choice of three door types: solid, acrylic, or glass.

Our wall cabinets with sliding doors are manufactured by your choice of either cold-rolled powder-coated steel or 304 stainless steel to accommodate different storage requirements. You can select from multiple widths and depths to configure the right sliding door wall cabinet for you.

Designed to be long-lasting and SEFA certified, our wall cabinets are the best for your storage needs.

Features

- 18 GA Sheet Metal Construction
- 3 Door Options: Acrylic, Solid, or Glass
- 1x Adjustable Shelf
- 2x Adjustable Shelves (Height > 24")



Understanding The Configuration Number

Using the model below, you will be able to better specify a cabinet configuration for your project.

WALL - **2** - **HHWWDD** - **2D** - **XS** - **A/W**

Cabinet Type Sliding Cabinet Dimensions Doors Door Type & Locking Pull/ Handle Type

Doors, Locking & Pull Details

| | | | |
|---|---|---|---|
| I. Doors <ul style="list-style-type: none">• 2 Door Requirement | II. Door Type <ul style="list-style-type: none">• S: Solid Door• A: Acrylic Door• G: Glass Door | III. Locking (Base & Wall) <ul style="list-style-type: none">• X : Locking• No for locks, leave blank. | IV. Pulls <ul style="list-style-type: none">• A: Aluminum Pull• W: Stainless Steel Wire Pull |
|---|---|---|---|

Example: WALL-2-303613-2D-XG-A

Wall Sliding Door Cabinet with 30" H x 36" W x 13", Locking Glass Door, Aluminum Pull

WALL SLIDING DOOR CABINET CONFIGURATIONS

HEIGHTS

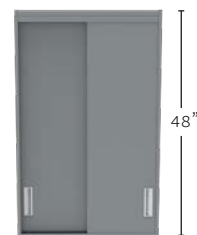

SOLID

WALL-2-HHWDD-2D-S-A/W



GLASS

WALL-2-HHWDD-2D-G-A/W



ACRYLIC

WALL-2-HHWDD-2D-A-A/W



WALL SLIDING DOOR CABINET CONFIGURATION OPTIONS

| HEIGHTS | WIDTHS | DEPTHS | DOORS |
|---------------------------------------|-----------------------------------|--|-------|
| 30", 36", 42", 48" | 18", 21", 24", 30", 36", 42", 48" | 13", 16" | 2 |
| DOOR | LOCKING | PULLS | |
| S = SOLID G = GLASS A = ACRYLIC | X = LOCKING SKIP FOR NO LOCKS | A = ALUMINUM PULL W = WIRE STAINLESS PULL | |

SLIDING DOOR CABINETS - TALL

Maximize your storage capacity while minimizing your footprint with our Tall Sliding Door Cabinets. Standing at a standard height of 84 inches, these cabinets are expertly engineered to provide unmatched storage capabilities, while their sliding doors ensure efficient use of space in your room.

Our tall cabinets are manufactured by your choice of either cold-rolled powder-coated steel or 304 stainless steel to accommodate different storage requirements. You can select from multiple widths and depths to configure the right tall cabinet for you.

Designed to be long-lasting and SEFA certified, our tall cabinets are the best option for more storage that takes up less room.

Features

- 18 GA Sheet Metal Construction
- 3 Door Options: Acrylic, Solid, or Glass
- 1x Adjustable Shelf
- 2x Adjustable Shelves (Height > 24")



Understanding The Configuration Number

Using the model below, you will be able to better specify a cabinet configuration for your project.

TALL - **2** - **HHWWDD** - **2D** - **XS** - **A/W**
Cabinet Type Sliding Cabinet Dimensions Doors Door Type & Locking Pull/ Handle Type

Doors, Locking & Pull Details

| | | | |
|---|---|---|---|
| I. Doors <ul style="list-style-type: none">• 2 Door Requirement | II. Door Type <ul style="list-style-type: none">• S: Solid Door• A: Acrylic Door• G: Glass Door | III. Locking (Base & Wall) <ul style="list-style-type: none">• X : Locking• No for locks, leave blank. | IV. Pulls <ul style="list-style-type: none">• A: Aluminum Pull• W: Stainless Steel Wire Pull |
|---|---|---|---|

Example: TALL-2-843016-2D-XG-A

Tall Sliding Door Cabinet with 84" H x 30" W x 16", Glass Locking Door, Aluminum Pull

TALL SLIDING DOOR CABINET CONFIGURATIONS

HEIGHTS

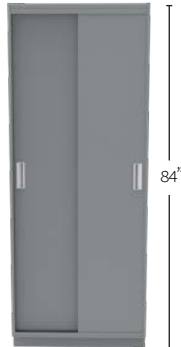

SOLID

TALL-2-HHWWDD-2D-S-A/W



GLASS

TALL-2-HHWWDD-2D-G-A/W



ACRYLIC

TALL-2-HHWWDD-2D-A-A/W



TALL SLIDING DOOR CABINET CONFIGURATION OPTIONS

| HEIGHT | WIDTHS | DEPTHS | DOORS |
|---------------------------------------|----------------------------------|--|-------|
| 84" | 30", 36", 42", 48" | 13", 16", 18", 22" | 2 |
| DOOR | LOCKING | PULLS | |
| S = SOLID G = GLASS A = ACRYLIC | X = LOCKING SKIP FOR NO LOCKS | A = ALUMINUM PULL W = WIRE STAINLESS PULL | |

MOBILE CABINETS

Whether your process requires it or if you just want to build the ultimate flexible lab, our mobile cabinets are a great solution. Furnishing your space with our mobile cabinets contributes to present-day adaptable and flexible space design techniques that are popular in any laboratory.

Mobile cabinets can be manufactured in cold-rolled powder-coated steel or 304 stainless steel to accommodate different area requirements. Designed to be long-lasting and SEFA certified, our mobile cabinets are the perfect addition to your workspace needs.

Features

- 18 GA Sheet Metal Construction
- Soft-Closing Drawers and Doors
- 1x Adjustable Shelf
- Plate Casters
- Standard 1" Metal Top or Lab Worksurface
- Anti-Tip Design
- Concealed Hinges
- Heavy-Duty Construction



Understanding The Configuration Number

Using the model below, you will be able to better specify a cabinet configuration for your project.

MOB

Cabinet Type

- HHWWDD

Cabinet Dimensions

- 01 L / R X

Doors, Drawers & Locking

- A/W

Pull/ Handle Type

Drawers, Doors, Locking & Pull Details

I. Drawers

- First Number: # of Drawers (0 to 5)

II. Doors

- Second Number: # of Doors (0 to 2)
- L or R: Left or right hinged single door.
- For double doors, leave blank.

III. Locking

- X : Locking
- No for locks, leave blank.

IV. Pulls

- A: Aluminum Pull
- W: Stainless Steel Wire Pull

Example: MOB-352122-40-A

Mobile Cabinet with 35" H x 21" W x 22" D, 4 Drawers, No Locking, Aluminum Pull

MOBILE CABINET CONFIGURATIONS

AVAILABLE HEIGHTS ARE LISTED ABOVE CONFIGURATIONS.
NOTE: HEIGHTS DO NOT ACCOUNT FOR THE 1" TOP THAT NEEDS TO BE SELECTED ON MOBILE CABINETS.

2 DRAWERS

MOB-HHWDD-10-A/W



3 DRAWERS

MOB-HHWDD-30-A/W



4 DRAWERS

MOB-HHWDD-40-A/W

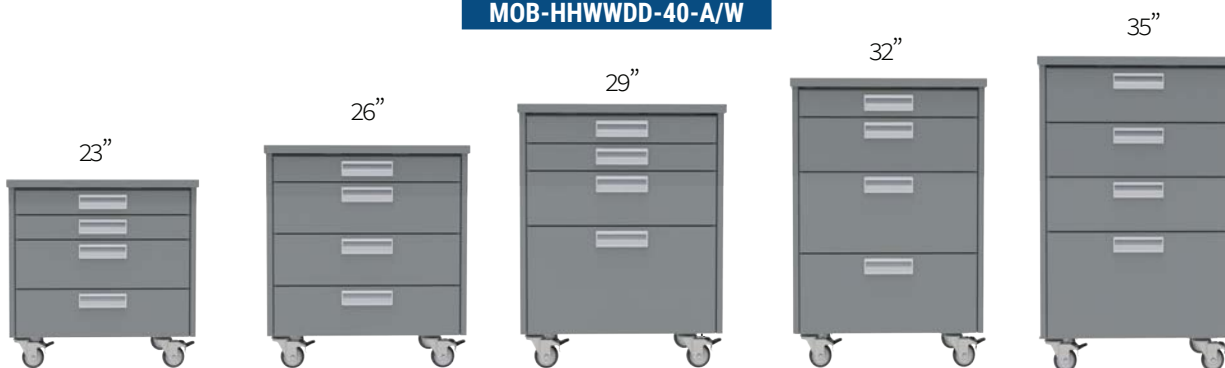

5 DRAWERS

MOB-HHWDD-50-A/W

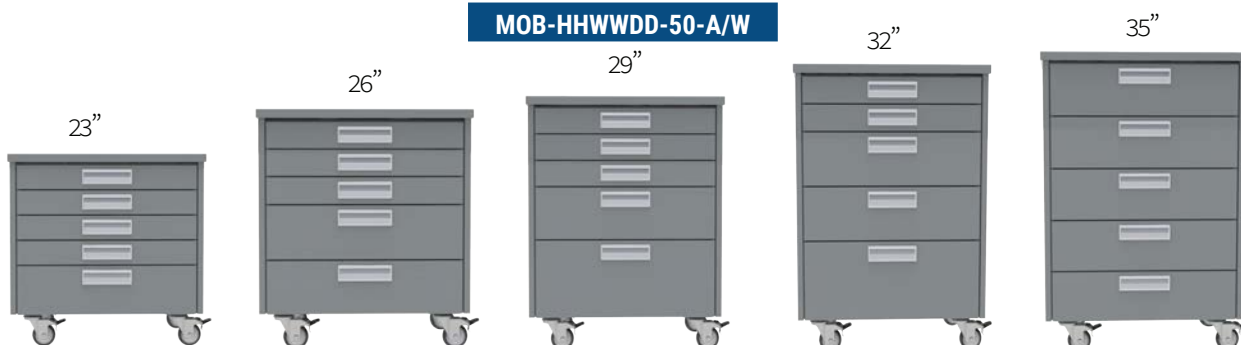

MOBILE CABINET CONFIGURATIONS

1 DOOR

MOB-HHWDD-01L/R-A/W



(L)



(R)

CABINETS WITH WIDTHS OF 24" OR LESS WILL HAVE (1) DOOR.

2 DOORS

MOB-HHWDD-02-A/W



CABINETS WITH WIDTHS OF 30" OR MORE WILL HAVE (2) DOORS.

DUAL COMBINATIONS



MOB-HHWDD-11L/R-A/W

AVAILABLE HEIGHTS:
ALL



MOB-HHWDD-12-A/W

AVAILABLE HEIGHTS:
26", 29", 32", 35"



MOB-HHWDD-22-A/W

AVAILABLE HEIGHTS:
26", 29", 32", 35"

MOBILE CABINET CONFIGURATION OPTIONS

| HEIGHTS | WIDTHS | DEPTHS | DRAWERS |
|-------------------------|---|----------------------------------|--|
| 23", 26", 29", 32', 35" | 15", 18", 21", 24", 30", 36", 42", 48" | 20", 22" | 0 TO 5 |
| DOORS | HINGE DIRECTION | LOCKING | PULLS |
| 0 TO 2 | L = LEFT R = RIGHT SKIP FOR DOUBLE DOOR | X = LOCKING SKIP FOR NO LOCKS | A = ALUMINUM PULL W = WIRE STAINLESS PULL |

CASEWORK ACCESSORIES - APRONS & FILLERS

Aprons are a great addition to your casework to create knee space for working or a storage area for mobile cabinets.



APRON-02WWDD

CONFIGURATION OPTIONS

| HEIGHTS | WIDTHS | DEPTHS |
|---------|----------|----------|
| 02" | 24"- 84" | 18", 22" |



APRON-04WWDD

CONFIGURATION OPTIONS

| HEIGHTS | WIDTHS | DEPTHS |
|---------|----------|---------------|
| 04" | 19"- 90" | 18", 22", 29" |



APRON-04WWDD-1A/WX OR -2A/WX

CONFIGURATION OPTIONS

| HEIGHTS | WIDTHS | DEPTHS | DRAWERS | LOCKING |
|---------|--|----------|---------|---------|
| 04" | 24"- 84" | 22", 29" | 1 TO 2 | X |
| PULLS | A= ALUMINUM PULL W= WIRE STAINLESS PULL | | | |

FILLERS

The walls of your environment may sometimes be off a little in terms of being vertical and straight. Fillers act as a bridge piece to align our perfectly square cabinets to an imperfect wall.

FRONT



REAR



WALL



CORNER



WALL CORNER



FFK-HHWW

RFK-HHWW

WFK-HHWWDD

CFK-HHWW

WCFK-HHWWDD

HEIGHTS

WIDTHS

DEPTHS

| | HEIGHTS | WIDTHS | DEPTHS |
|-------------|---|--|----------|
| FFK | 29", 32", 35", 41" | 1"-14" (35") HEIGHT HAS AN ADDITIONAL WIDTH OF 25" | N/A |
| RFK | 29", 32", 35", 41" | 5"-20" (ALL HEIGHTS), 21"-25" (35" & 41" HEIGHTS ONLY) | N/A |
| WFK | 18", 19", 24", 25", 30", 31", 36", 42", 48" | 1"-14" | 13", 16" |
| CFK | 29", 32", 35", 41" | 1"-8" | N/A |
| WCFK | 18", 19", 24", 25", 30", 31", 36", 42", 48" | 1"-6" | 13", 16" |

CASEWORK ACCESSORIES - SHELVING SYSTEMS

We offer (3) kinds of shelving systems: wall, reagent and island. Each provides you with option of creating addition shelving accessibility.

ISLAND



ISS-HHWDD-(1,2,3 ROWS)

CONFIGURATION OPTIONS

| | |
|---------|-----------------------------|
| HEIGHTS | 48" |
| WIDTHS | 32"-218" (BY 6" INCREMENTS) |
| ROWS | 1, 2, 3 |

Our island shelving is perfect for when you want to add shelving lab island (out of casework). Customize from multiple combinations to create the right system for your laboratory island.

***NOTE:** Our island shelving **cannot** be added to preexisting furniture manufactured by a third party manufacturer or entity.

REAGENT



RSS-HHWDD-(L)

CONFIGURATION OPTIONS

| | |
|---------|---|
| HEIGHTS | 12", 24", 36" |
| WIDTHS | 106"-234" (BY 12" INCREMENTS) 234"-294" (BY 6" INCREMENTS) |
| DEPTHS | 12", 18", 24" |
| LIPS | L = WITH LIPS LEAVE BLANK FOR NO LIPS |

Our reagent shelving is perfect for when you want to add shelving to a lab island or table. Customize from multiple combinations to create the right reagent system for your work area.

***NOTE:** Our reagent shelving **cannot** be added to preexisting furniture manufactured by a third party manufacturer or entity.

WALL

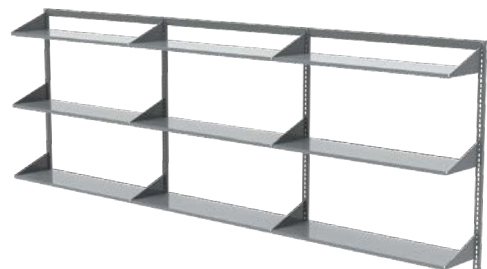

WSS-HHWDD-(1,2,3, ROWS)

CONFIGURATION OPTIONS

| | |
|---------|------------------------------|
| HEIGHTS | 18", 24", 30", 36", 42", 48" |
| WIDTHS | 26"-164" (BY 6" INCREMENTS) |
| DEPTHS | 13", 16" |
| ROWS | 1, 2, 3 |

Our wall shelving is perfect when you want to utilize all areas in your work space. Customize from multiple combinations to create the right wall system for you.

CASEWORK ACCESSORIES - SCRIBES

Scribes are needed to close a gap (if present) between the worksurface depth and depth of cabinets.

FRONT



FSK-HHWW

CONFIGURATION OPTIONS

| | |
|---------|---|
| HEIGHTS | 29", 32", 35", 41", 56", 84", 96" |
| WIDTHS | 29", 32", 35", 41" : 1"-20" 56" & 96" : 6" 84" : 1"-15" |

REAR



RSK-HHWW

CONFIGURATION OPTIONS

| | |
|---------|---|
| HEIGHTS | 29", 32", 35", 41", 84", |
| WIDTHS | 29" : 1"-24", 1.5" 32" : 1"-24", 1.5", 30" 35" : 1"-24", 1.5", 2.5", 27", 28", 33", 42" 41" : 1"-22", 24" 84" : 1", 2", 4", 11" |

CORNER



CSK-HHWW

CONFIGURATION OPTIONS

| | |
|---------|----------|
| HEIGHTS | 29", 35" |
| WIDTHS | 1"-12" |

WALL



WSK-HHWWDD

CONFIGURATION OPTIONS

| | |
|---------|--|
| HEIGHTS | 18", 19", 24", 25", 30", 31", 36", 42", 48" |
| WIDTHS | 1"-14" (1.5") WIDTH ALSO AVAILABLE FOR ALL HEIGHTS BUT ONLY AT A (13") DEPTH. |
| DEPTHS | 13", 16" |

CASEWORK ACCESSORIES - MISCELLANEOUS

Below are (4) different accessories that you can add to your casework designed by OnePointe Solutions.

SERVICE CHASE



SCA-HHWWDD-(H)

CONFIGURATION OPTIONS

| | |
|---------|-----------------------------------|
| HEIGHTS | 61"-95" (BY 1' INCREMENTS) |
| WIDTHS | 12", 14", 16", 18", 20", 22", 24" |
| DEPTHS | 06", 08" |
| HOLES | H = HOLES |

Our service chases are a great addition to lab islands and tables when you need to run certain services or wires through while still keeping them concealed and protected.

***NOTE:** Our service chases **cannot** be added to preexisting furniture manufactured by a third party manufacturer or entity.

SLOPED TOP



STA-DDWW

CONFIGURATION OPTIONS

| | |
|---------|---------|
| HEIGHTS | 08" |
| WIDTHS | 12"-48" |
| DEPTHS | 16" |

Pairing well with out wall and tall cabinets, our sloped tops are ideal for spaces where you don't want dust to collect on top of casework.

***NOTE:** Our sloped tops **cannot** be added to preexisting furniture manufactured by a third party manufacturer or entity.

FINISHED BACK PANEL



FBACK-HHWW

CONFIGURATION OPTIONS

| | |
|---------|--|
| HEIGHTS | 29", 32", 35", 41", 84" |
| WIDTHS | 12", 15", 18", 21", 24", 30", 33", 36", 42", 48" |

Our finished back panels are ideal for casework that may be against a glass/transparent wall or no wall at all. They help to cover the exposed backs of casework that is normally hidden if against a typical wall or aligned back to back of each other.

***NOTE:** Our finished back panels **cannot** be added to preexisting furniture manufactured by a third party manufacturer or entity.

REAR ENCLOSURE END PANEL

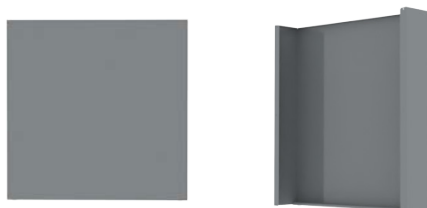

REPK-HHWWDD

CONFIGURATION OPTIONS

| | |
|---------|--|
| HEIGHTS | 29", 32", 35", 41" |
| WIDTHS | 15", 18", 21", 24", 30", 36", 42", 48", 54", 60" |
| DEPTHS | 03", 06", 07" |

Rear enclosure end panels help to cover the exposed backs of casework that is normally hidden if against a typical wall or aligned back to back of each other, just like finished back panels.

***NOTE:** Our rear enclosure end panels **cannot** be added to preexisting furniture manufactured by a third party manufacturer or entity.

CASEWORK ACCESSORIES - CONCEALED HINGES



APPEARANCE



HINGE MOTION



INNOVATIVE TECHNOLOGY



SILENT & EFFORTLESS MOTION

Features

SEFA Certified | Quieter Lab | Tested to 100,000 Cycles | Three Dimensional Adjustments | No Institutional Exposed Hinges

LABORATORY SURFACES

Epoxy Resin



Epoxy resin is a quality material that is resistant to most chemicals, moisture, impact, and heat; it's the ideal solution for environments that are very corrosive or have a high level of moisture.

Phenolic Resin



Phenolic resin countertops and tabletops meet the requirements of most laboratories while including additional benefits such as chemical, wear, and water resistance.

Stainless Steel



Stainless steel is the ultimate solution for adding resistance to your workspace. As a nonporous surface, no liquid or substance can penetrate into the material; bacteria, mold, and other common germs don't stand a chance.

ESD Laminate

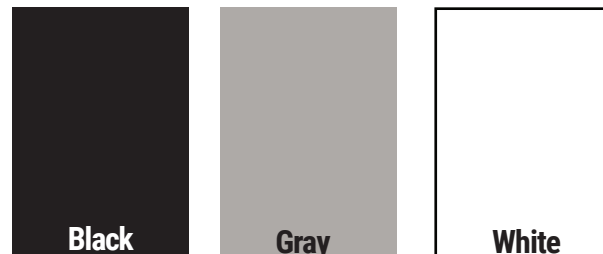

ESD Laminate or electro-static dissipative laminate is specifically designed to prevent the discharge of built-up static electricity that can damage sensitive equipment.

Solicor-CR

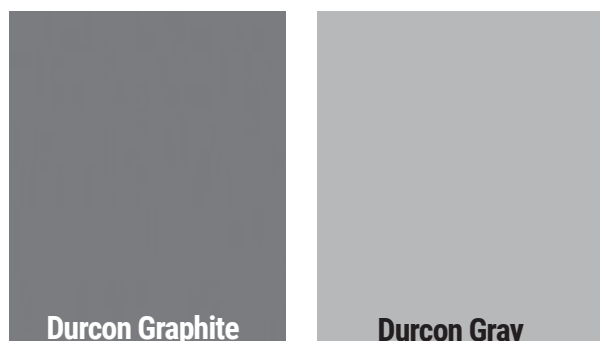

Solicor-CR is a lab-grade surface material well suited for environments, where chemical resistance, durability and aesthetics are top priorities.

HDPE



High-Density Polyethylene (HDPE) tops are lightweight and provide a non-absorbent and stain-free surface that is best used for food preparation.

*FDA approved & NSF Standard 51 certified

COMMERCIAL SURFACES

Maple Block



In the material handling business, there's no better than maple block. Maple works hard in factories, and on shipping and receiving docks around the world.

Granite



Granite countertops are an elegant, timeless, and extremely durable surface option. They bring any commercial or industrial space to life with its many colors and smooth finish.

For our granite countertop colors, please contact us.

Quartz



Quartz countertops are favored by designers in various commercial industries since quartz can easily withstand extended use, regular cleaning, and exposure to moderate heat, moisture, and most household/commercial cleaners.

For our quartz countertop colors, please contact us.

Plastic Laminate



Made to align perfectly with your target aesthetic, layout, and budget. From breakrooms and reception areas to conference rooms, classrooms and even laboratories, plastic laminate countertops complement virtually any environment it is in.

For our plastic laminate countertop colors, please contact us.

Wilsonart® Solid Surface

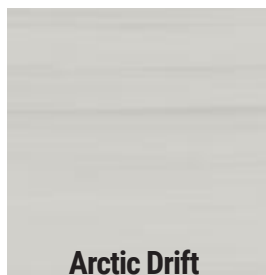

Arctic Drift

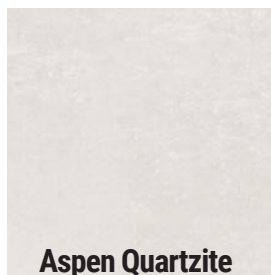

Aspen Quartzite



Calming Waves

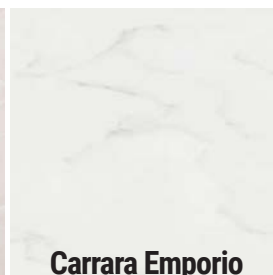

Carrara Emporio

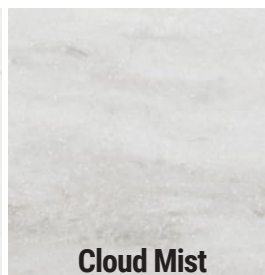

Cloud Mist



Ice Statuario

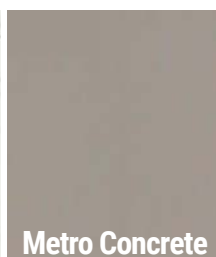

Metro Concrete

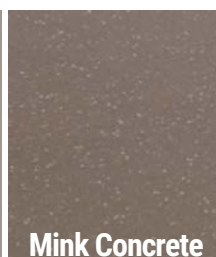

Mink Concrete

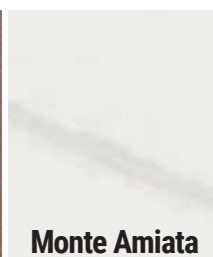

Monte Amiata

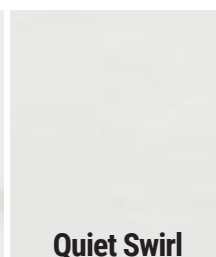

Quiet Swirl

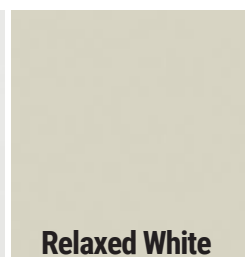

Relaxed White

At OnePointe Solutions, we carry a plethora of Wilsonart® Solid Surface options. Wilsonart® Solid Surface countertops are great for use in many settings: office, retail, industrial, healthcare, education and in certain laboratory settings. It is a nonporous, seamless, elegant material that can mimic the look of granite, marble, and even stone. For more solid surface options, please contact us.

POWDER COAT OPTIONS

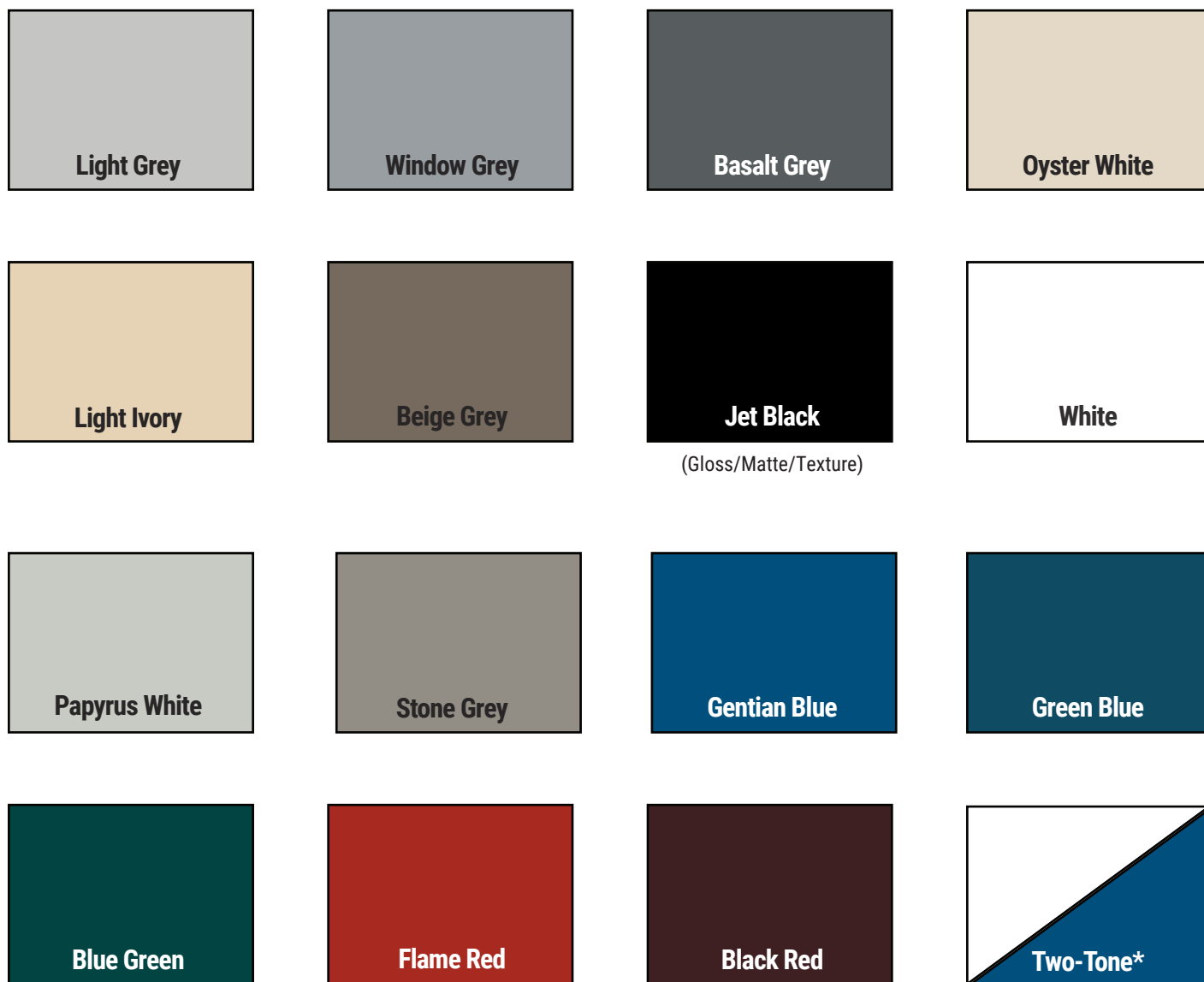

*Available Upon Request

NON-COLOR OPTIONS



NEED A CUSTOM COLOR?

Want a color you do not see? No worries we can help you get virtually any color for your casework. What are you looking for? A certain red? Deep blue? Special white? Let us know and we will do our best to get you virtually any color in the color wheel and even those that are not too. Our fabrications can be faced with a wide selection of hues and finishes, from bold to subdued. ***Note: Some colors may require a minimum order. ***

HANDLES & PULLS

Stainless Steel Wire Pulls



Aluminum Recessed Handles

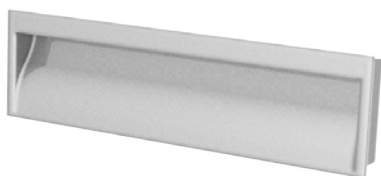

Powder Coat Options Available



Black Recessed Handles

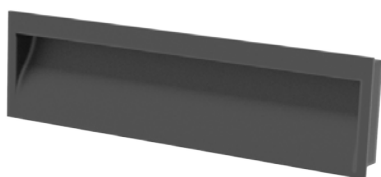

Custom Pull Options Available



FUME HOODS & LAB FIXTURES



FUME HOODS - PEGBOARDS/DRYING RACKS



UL VERIFIED RACEWAYS



LAB GRADE FAUCETS - GAS VALVES - EYE WASH STATIONS - SINKS

IMPORTANT INFORMATION

CONTACT US

1112 Swenson Blvd, Elgin, Texas 78621 | (866) 612-7312

www.onepointesolutions.com | info@onepointesolutions.com

NATIONWIDE SERVICE

Our team travels to you to make sure that we understand your needs, get the right measurements, and install the final product on time. Our projects can be found in: New York, Chicago, Los Angeles, San Antonio, Dallas, Houston, Atlanta, Cheyenne, Des Moines, San Diego, Washington DC, San Francisco, Nashville, Honolulu, and just about everywhere else. Want to view a reference project in your area? Just ask!



NOTES

NOTES

NOTES

NOTES

ONEPOINTE SOLUTIONS



(866) 612-7312

www.onepointesolutions.com