



# ONEPOINTE SOLUTIONS

## DENTAL LAB WORKSTATIONS



*Empowering Dental Innovation with Premium Workstations*



(866) 612-7312  
[onepointesolutions.com](http://onepointesolutions.com)

# FLEX DENTAL WORKSTATION



## Overview

OnePointe Solutions' Dental Benches offer reliability, functionality, and organization in an esthetically pleasing ergonomic design. Users have the choice of single, double, pedestal, and custom benches - all of which can accommodate the personal needs of each technician.

OnePointe Solutions has provided the designing, building, and installing of dental lab benches for dental laboratories across both commercial and dental office laboratories, as well as universities, Veterans Administration facilities, military hospitals, and clinics.

## Features

- Variable speed dust collector with automatic and manual settings
- Modern removable dust hood with shield
- Motor control panel with lighted power switch and indicator lights, with optional task lighting
- Stainless steel scrap drawer
- Magnifying lens
- Gas valve and retractable air blowgun with regulator
- Optional lab handpiece
- Single, side-to-side, back-to-rack, and custom benches

# TRADITIONAL DENTAL LAB WORKSTATION

## Overview

Each of OnePointe Solutions' Dental workstations has the **option** to come with a quiet, powerful, vibration-free, fractional horsepower, variable-speed dust collector motor with a lighted power switch. Dust is collected in a unique, disposable filter bag.

The dust collector motor may be operated in either manual mode, when the power switch operates the dust collector motor, or automatic mode when the electric handpiece controls the dust collector motor.

The control panel includes indicator lights, which monitor the performance of the filter bag and dust collector motor. Exceptional shadow-free lighting is provided by two 55-Watt color-correct fluorescent tubes.



## Optional Features

- Individual dust collecting system with removable suction hood and safety shield
- 2.5X magnifying lens\*
- Large magnetic vinyl top saver
- Removable stainless steel scrap drawer, and removable, adjustable arm boards\*
- Single workstations, pre-piped for gas and air, pre-wired for electricity
- AGA-approved gas valve for Bunsen burner and OSHA-compliant air gun with regulator
- 110-watt color correct full-spectrum fixed height lighting system with two case pan storage shelves

# DENTAL LABORATORY RUN

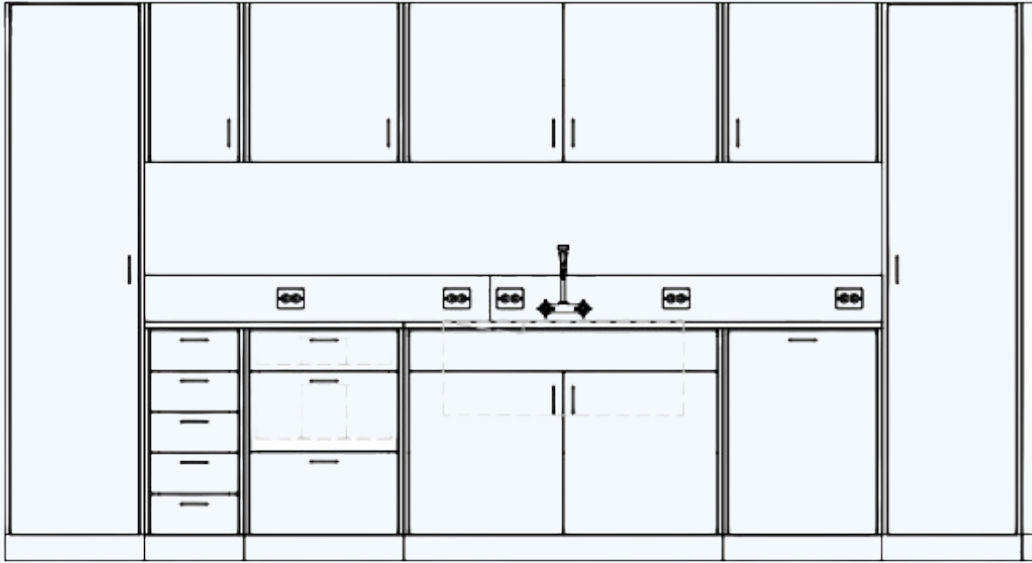

## Overview

OnePointe Solutions' Dental Workstations are available with a wide variety of options. Select the options you want to build a lab bench that suits your specific requirements at a surprisingly affordable price.

Dental workstations feature all-steel construction with a durable powder coating finish to resist chipping and scratching—functional features to make your work easier and more precise.

## Features

- Casework
  - Base Cabinets (*Drawer & Door Combinations Available*)
  - Waste Bin Cabinet
  - Sink Cabinet
  - Wall Cabinets
  - Tall Cabinets
- Custom Electrical Backsplash w/ Cutouts
- Tray Slope
- Compressed Air Holes

# PEDESTAL ISLAND WORKSTATION



## Overview

The pedestal workstation by OPS is the laboratory industry's first practical and affordable technician workstation with a built-in dust collecting system. Suction is provided for up to 4 technicians by a quiet, powerful, vibration-free 1 hp. brushless motor.

A blastgate at each workstation allows the technician to control suction at the workstation. A unique cartridge filter with 75 square feet of filter area captures particulate as small as 0.5 microns. Because the pedestal workstation does not require legs for support, floor maintenance is easier and technicians can move their stools conveniently between workstations.

Pedestal workstations can be arranged side by side and face to face.

