

### "IMPORTANT SAFETY INSTRUCTIONS"

This portable Luminaire has a polarized plug (one blade is wider than the other) as a safety feature to reduce the risk of electric shock. This plug will fit in a polarized outlet only one way. If the plug does not fit fully in the outlet, reverse the plug. If it still does not fit, contact a qualified electrician. Never use with an extension cord unless the plug can be fully inserted. Do not alter the plug.

### MOUNTING INFORMATION

1. Read all instructions.
2. The maximum distance between the Portable Luminaire and the receptacle should not exceed the length of the supply cable.
3. For best results, have lighting professionally installed by a qualified Licensed Electrician.
4. Interconnection of fixtures must remain within the current rating and the maximum number of units in accordance with the table below:

Model	Input Voltage (Vac)	Input Current (A)	Input Wattage (W)	Maximum Number of Interconnected units
EL12-LED/277	100~277Vac	0.018~0.050 A	5 W	Maximum 70 units interconnected
EL18-LED/277	100~277Vac	0.022~0.060 A	6 W	Maximum 60 units interconnected
EL22-LED/277	100~277Vac	0.032~0.090 A	9 W	Maximum 40 units interconnected
EL29-LED/277	100~277Vac	0.040~0.110 A	11 W	Maximum 33 units interconnected
EL34-LED/277	100~277Vac	0.040~0.120 A	12 W	Maximum 30 units interconnected
EL46-LED/277	100~277Vac	0.050~0.150 A	15 W	Maximum 24 units interconnected
EL59-LED/277	100~277Vac	0.060~0.180 A	18 W	Maximum 20 units interconnected

**Max. power 400W for all interconnected units.**

5. The Maximum distance between interconnected units should not exceed the length of the interconnecting cable.
6. There are no user serviceable parts inside light. Do not open fixture or damage may result and will void warranty.
7. The LEDs on this fixture are not user serviceable. The LED strip cannot be replaced.
8. This unit is NOT dimmable. Do not connect to a dimmer or damage to the light may result.
9. This unit is suitable for surface or recessed mounting
10. The LEDs on this fixture are not user serviceable. The LED strip cannot be replaced.
11. This unit shall be attached to a mounting surface such as metal or wood, and if attached to drywall, the screws shall penetrate the drywall and still allow 1/2 inch to penetrate stud
12. SAVE THESE INSTRUCTIONS

# INSTALLATION

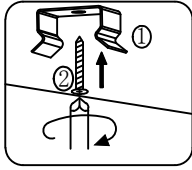

**Step 1:** Attach mounting clips (1) to desired surface with enclosed screws(2)

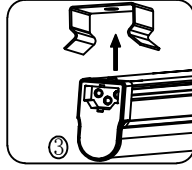

**Step 2:** Snap or slide light (3) into the clips

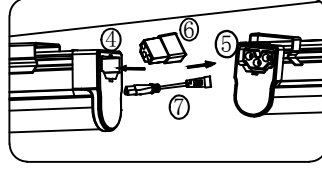

**Step 3:** Multiple units (4&5) can be interconnected using the supplied Direct Connector (6) or an optional Connecting Cable (7).

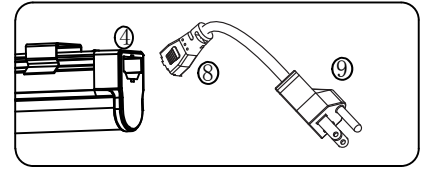

**Step 4:** For 120/220 Vac operation, connect Power Cable (8) to Light (4). Then connect Power Cable (9) to outlet.

## Technical Specifications

Input Voltage: 100~277VAC only

Input Frequency: 60Hz

Power Factor:  $\lambda > 0.9$

Ambient Temperature: 0°C ~ 30°C

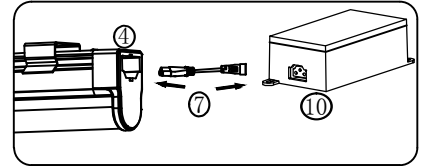

**Step 4:** For 277 Vac operation, or optional 120/220Vac operation, use Hardwire Box adapter(10). Attach Connecting Cable (7) to Light (4) then attach to Hardwire Box connector.

## Parts Diagram

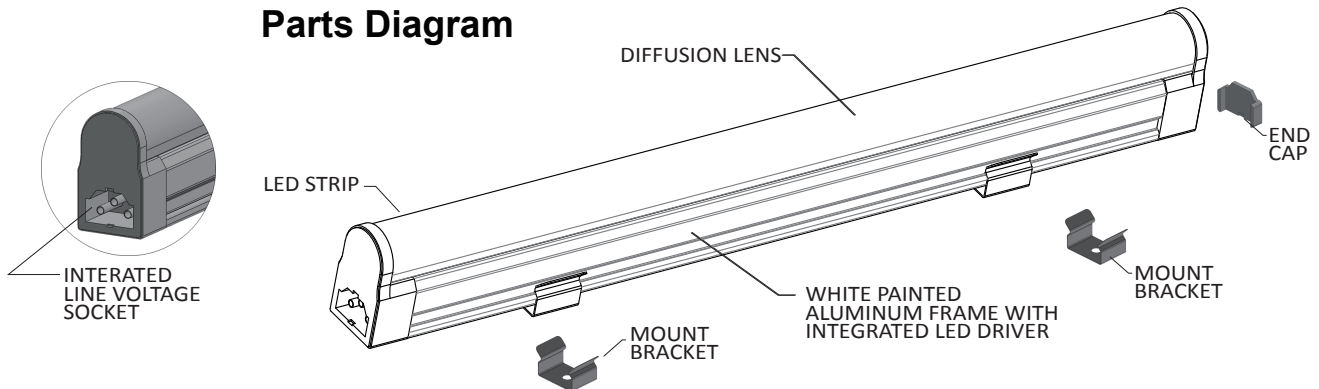

## HARDWIRE BOX INSTALLATION INSTRUCTIONS

- Remove the 1/2" knockout with a flat head screwdriver.
- Remove the four screws from the box cover and remove top. Select an appropriate fitting for the type of 1/2" trade conduit or wiring that will be used and install in the knockout.
- Mount box to the desired surface using the two tabs with appropriate screws.
- Strip 1/2" insulation from the supply wiring and run through the fitting. Connect the wires to the terminal block as follows: Red or Black wire to "L", White wire to "N", Green or bare wire to  symbol.
- Replace the box cover and secure with four screws. Secure fitting to conduit if needed.
- Connect the first fixture to the box connector with a Direct Connector or one of the Connecting Cables.

*Please call 1-800-336-HERA for further assistance if needed.*

**Cleaning Instructions:** Only clean with a mild cleaning agent using a soft cloth