

# OnePointe Solutions Case Study

## **NEW NUCLEAR MAGNETIC RESONANCE ROOM**

### Laboratory Design & Build

## **THE ORGANIZATION**

Kraton Polymers develops, manufactures and markets biobased chemicals and specialty polymers that deliver exceptional value and enhance the lives of people all over the world.

## **THE PROBLEM**

Kraton had a NMR room that needed remodeling in preparation for the installation of their new NMR unit. The remodeling included getting new furniture, but there was a problem. The NMR was a big magnet, so the furniture needed to be metal free, meaning they couldn't use regular lab furniture. They also needed removal of their old cabinets and installation of new cabinets. They reached out to OnePointe Solutions to see if we could help. We're we ready to make their NMR room possible.

## **INVOLVED PARTIES**

OnePointe Solutions

Kraton Polymers

# ✦ OnePointe Solutions Case Study

## NEW NUCLEAR MAGNETIC RESONANCE ROOM

### Laboratory Design & Build

## THE PROJECT

The client requested a custom L shape desk with letter size file cabinets on both ends and round front. In addition, they wanted lower storage cabinet at the right end of the desk with two doors and 1 removal shelf, for probes storage. They also asked for taller storage cabinets with two doors and adjustable shelves for storing their materials as well.

Since this project could not involve metal of any kind, we supplied the client with a phenolic resin countertop for the custom table and PLAM cabinets.

## Technical Specifications

Custom Table

Tall Cabinet

Lower Storage Cabinets

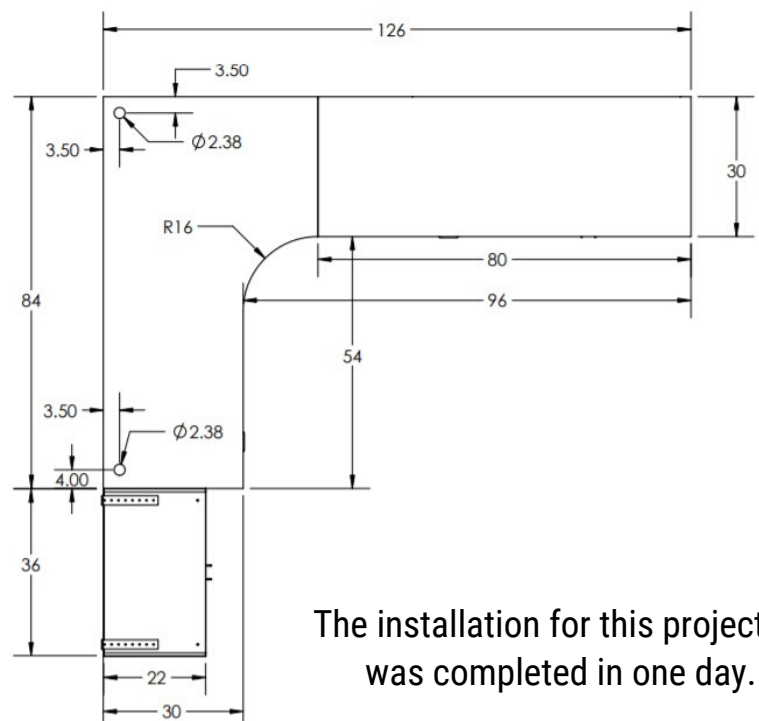
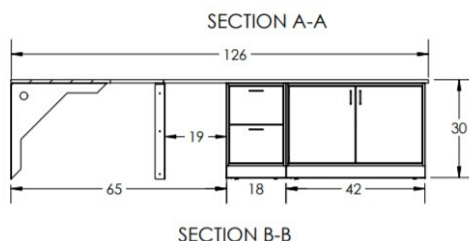
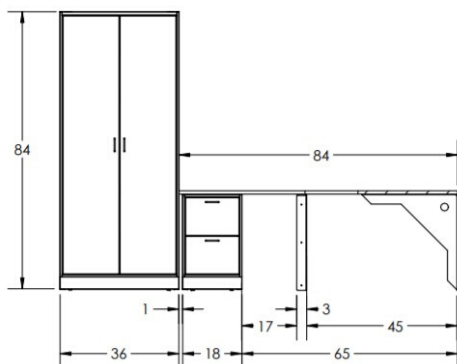
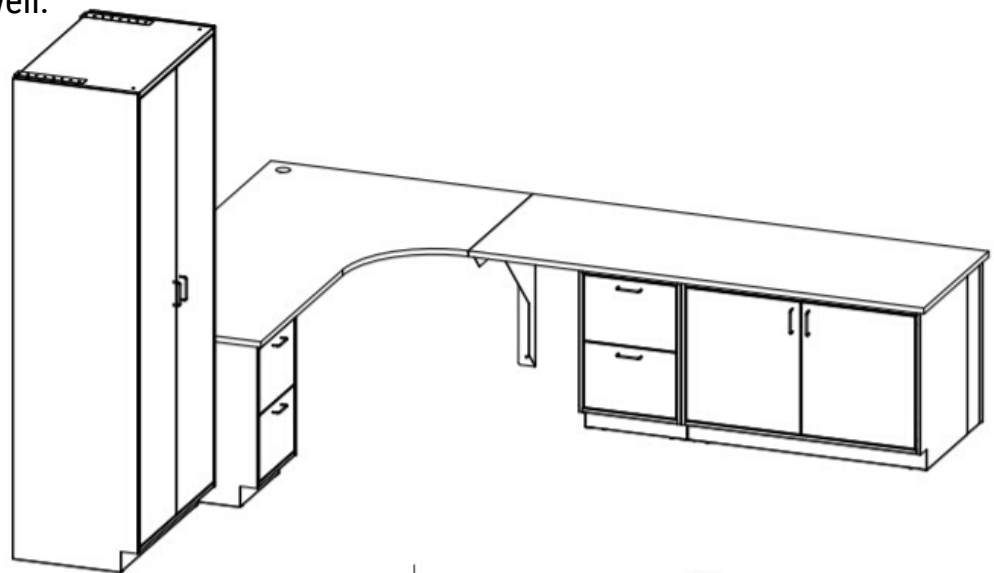

The installation for this project was completed in one day.

# ✦ OnePointe Solutions Case Study

## NEW NUCLEAR MAGNETIC RESONANCE ROOM

### Laboratory Design & Build

## THE RESULTS



## Our Guarantee

*At OnePointe Solutions, we guarantee that we can furnish or renovate your existing space at the best value without sacrificing quality. Our team of designers and builders will work with you to create a perfect fit for your ideal lab or work space.*